

✓EFL 130.300m... Roof
 ✓EFL 127.300m... Level 13 Thirteenth Floor
 ✓EFL 124.300m... Level 12 Twelfth Floor
 ✓EFL 121.300m... Level 11 Eleventh Floor
 ✓EFL 118.300m... Level 10 Tenth Floor
 ✓EFL 115.300m... Level 09 Ninth Floor
 ✓EFL 112.300m... Level 08 Eighth Floor
 ✓EFL 109.300m... Level 07 Seventh Floor
 ✓EFL 106.300m... Level 06 Sixth Floor
 ✓EFL 103.300m... Level 05 Fifth Floor
 ✓EFL 100.300m... Level 04 Fourth Floor
 ✓EFL 97.300m... Level 03 Third Floor
 ✓EFL 94.300m... Level 02 Second Floor
 ✓EFL 91.300m... Level 01 First Floor
 ✓EFL 88.225m... Level 0M Mezzanine
 ✓EFL 85.300m... Level 00 Ground Floor

1 Proposed Elevation B: Northwest Elevation to Boulevard
Scale: 1:200 @ A0

2 Internal Elevation E: Internal Courtyard Southeast Facing
Scale: 1:200 @ A0

Proposed Elevations B and E
 - - - Area of proposed amenity(s)
 - - - Outline of Permitted Scheme under Planning Application ABP Ref. 304405-19

- MATERIAL REFERENCES**
1. Articulated Solid and/or Insulated Render Panel Façade (white) to Detail
 2. Articulated Solid and/or Insulated Render Panel Façade to Select Colour to Detail
 3. Brick Facing to Select Colour to Detail
 4. PPC Aluminium Framed Glazing & Doors
 5. PPC Aluminium Framed Glazed Curtain Walling
 6. Glazed Balcony and Walkway Guard Rail to Detail
 7. Solid Panel Balcony and Walkway Guard Rail to Detail
 8. PPC Horizontal Louvre Screen to Detail
 9. PPC Vertical Screen Screening to Select Colours and Detail
 10. Green Sedum Roof

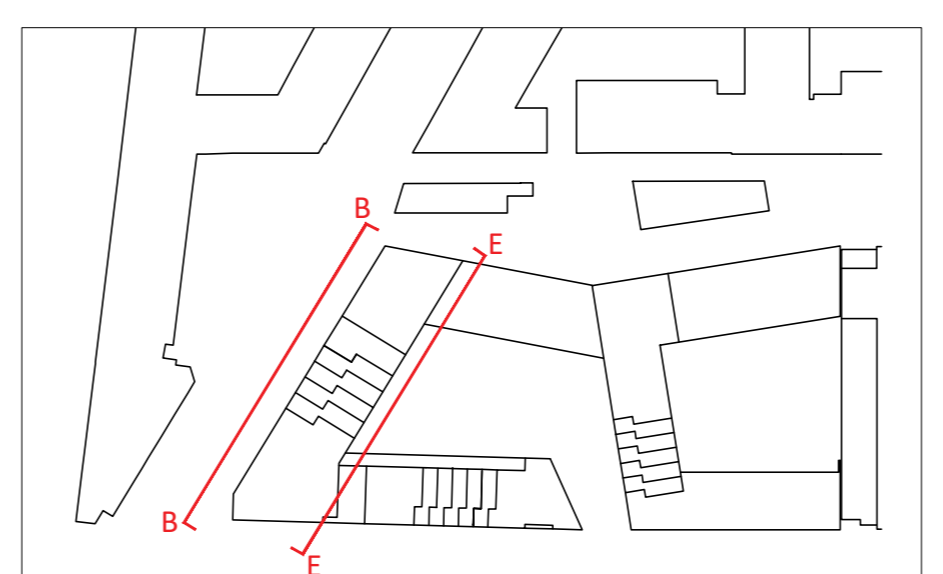

Revision Description	Date	Rev. No.	Issued by
Issued for Planning - LRD Application	28-07-2023	001	MM
Any reference to fire safety design or performance is presented for coordination purposes only. Refer only to the granted Fire Safety Certificate, and fire consultant's information for fire safety design, specification and performance.			
Figured dimensions only to be used. This drawing is copyright of O'Mahony Pike Architects Ltd. All information is shared as per approved use in accordance with ISO19650-2:2018, Table 5; Standard Codes for Suitability of Models and Documents and the BEP. If the 'Status' field is empty, this information has been shared at 50 - WIP.			

o'mahony pike

architecture | urban design
 email: info@omahonypike.com
 tel: +353 1 202 7400
 fax: +353 1 283 0822
 www.omahonypike.com

Dublin
 The Chapel
 Mount St. Anne's
 Milltown, Dublin 6
 D06 XN52 Ireland

Cork
 One South Mall
 Cork City
 Co. Cork
 T12 CCN3 Ireland

Project Code: RBK
 Project Lead: CK/AS
 Drawn By: AW/CC
 Job No.: 23010
 Purpose: Planning

Scale @ A0: 1:200
 Date Printed: 28-07-2023
 Current Rev.: C01
 Status: A3

Project: Rockbrook
 Location: Carmanhall Road, Sandyford, Dublin 18
 Client: Expert Eye Property Company Limited

Drawing Title: Proposed Elevations B & E
 Drawing No.: 23010-OMP-PA1-ZZ-DR-A-2001

All levels (in meters) are related to Malin head. All dimensions in millimeters. Figured dimensions only are to be taken from this drawing.